

# Full Height Turnstile

## DST80 Tiffany Series

Interior & Exterior Application

Available in your choice of natural aluminum clear finish, anodized bronze or black. These highly durable, tamper-resistant turnstiles are the ideal choice where security and style meet. They will control passage through a fence perimeter, parking or factory entrance, military installation, sports venue or even an office building. Available in single and tandem configuration.



DST80 Series



(shown with optional integrated metal detection portal)

### FEATURES & BENEFITS

- Weather resistant finish in your choice of clear, dark bronze or black
- Automatic indent Feather-Touch action that includes shock suppressor technology and a non-entrapment design
- Minimal exposed hardware
- Meets ASTM standards
- Aesthetically pleasing

**DSI**<sup>®</sup>  
DESIGNED SECURITY, INC.  
*Building Security*

1402 Hawthorne St.  
Bastrop, TX 78602  
Voice: 1-800-272-3555  
Fax: 1-512-321-9181  
E-mail: [dsi@dsigo.com](mailto:dsi@dsigo.com)  
[www.dsigo.com](http://www.dsigo.com)

# DST80 Series - Interior & Exterior Application

## Applications:

The DST80 is a three-vane turnstile with a weather resistant finish and is ideal for interior or exterior placement - wherever style and durability are needed. It is crafted of 6005-T6 aluminum extrusions and features GE's transparent Lexan polycarbonate cage panels.

## Product Features:

### Materials and Finishes available in your choice of:

- Clear, Dark Bronze or Black
- Performance features include automatic indent Feather-Touch action - that includes shock suppressor technology and a non-entrapment design

## Design & Construction:

- Designed for secure operation with aesthetics in mind.
- Features minimal exposed hardware and meets ASTM standards

## Controller &

### Access Control Operation:

- Self-centering control head with adjustable hydraulic shock suppression
- Hardened tool steel locking bars, cam and roller assemblies
- Permanently lubricated bearings
- All units are available in clockwise, counter-clockwise or bi-directional passage

## Measures:

### DST80S (Single)

#### Exterior Height

89.5"

#### Width

65.68"

#### Pedestrian Clearance

30"

### DST80T (Tandem)

#### Exterior Height

89.5"

#### Width

96.16"

#### Pedestrian Clearance

30"

## Options:

- Electronic locking module featuring heavy-duty 24 vdc pull-type industrial solenoids and card reader interface
- Available in Fail-Safe (open on power failure) or Fail-Lock (lock on power failure) modes
- Can interface with card readers, computer attendance systems, coin and token acceptors, push buttons, wireless remote controls and metal detectors
- Electronic 6 digit resettable counter with LCD display and seven-year lithium battery
- Vertical Graphic Array (VGA) red x / green arrow
- Additional options available on request

## Electrical Specifications:

Command Module input 110-240

VAC (2 amp-1 amp) 50-60 Hz;

control voltage 24 VDC.

All electrical components are UL recognized and CSA certified

## Warranty:

Units are warranted against defects in materials and workmanship for a period of one year from date of invoice.

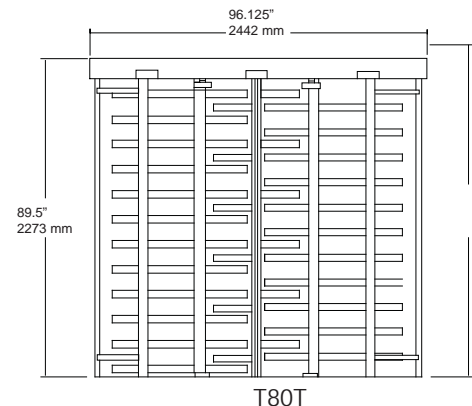
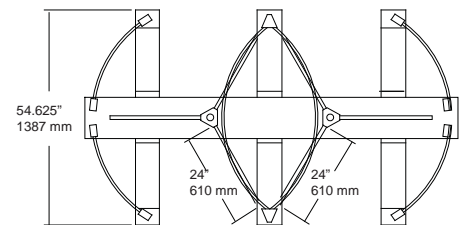
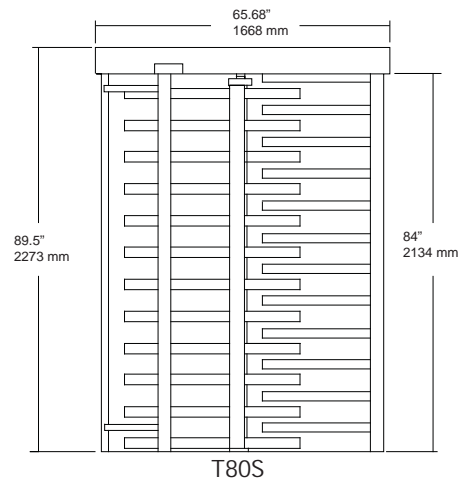
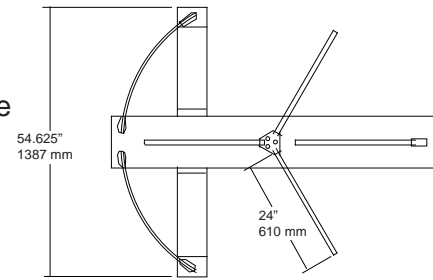

**DSI**<sup>®</sup>  
DESIGNED SECURITY, INC.  
*Building Security*

1402 Hawthorne St.  
Bastrop, TX 78602  
Voice: 1-800-272-3555  
Fax: 1-512-321-9181  
E-mail: [dsi@dsigo.com](mailto:dsi@dsigo.com)  
[www.dsigo.com](http://www.dsigo.com)